

Bromley Health and Wellbeing Centre – Project Update

Tom Downard – on behalf of NHS South East London Integrated
Care Board

December 2022

Welcome and introduction

Thank you for joining our online public event.

- The event will be recorded. Please keep you microphone off, and if you prefer, switch off your camera.
- You can share your questions in the chat or by raising your hand, we will cover as many questions as we can during the Q&A session.

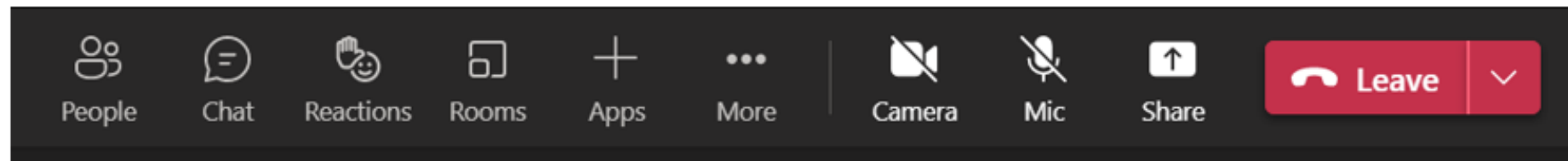

↓
Access the chat

↓
Raise you hand for questions

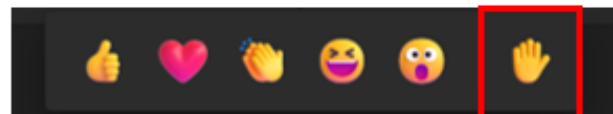

↓
Switch microphone on/off

↓
Switch camera on/off

Agenda

- What we are aiming to achieve
- Choosing the site
- Benefits to patients and the local community
- Developing our plans
- How will our plans impact you?
- Designs
- Timelines
- How you can find out more and get involved
- Next steps
- Questions

What are we aiming to achieve?

A Health and Wellbeing Centre in Bromley Town will help us to:

- Provide fit for purpose buildings for current and future primary care services
- Ensure that there is sufficient capacity for primary care to meet future demand
- Enable the rollout of more health and wellbeing services in the local community
- Support Bromley health and care organisations to deliver services closer to the communities they serve
- Provide a sustainable estates solution for the long term

Choosing the site

- In 2017, a property search was undertaken which concluded that there were 12 potentially suitable sites
- 6 of the 12 were discounted as not meeting the required criteria (around location, disability access, access to public transport etc)
- The remaining 6 were appraised and the most credible and financially viable option was the Adventure Kingdom site, located adjacent to the Bromley Civic Centre in the town centre.



Benefits to patients and the local community

Introduction of new health and wellbeing services

More staff will make it easier and quicker for people to be able to see a health professional

Excellent public transport links (16 bus routes stop at the Bromley Civic Centre)

Reduced need to attend hospital for outpatient appointments

Improved access ensuring the building is fully accessible by those with mobility issues and by central location in Bromley

Five minute walk to the Glades Shopping Centre

New staff for patients to see as an alternative to a GP (paramedics, physiotherapists, pharmacists etc)

Excellent car parking facilities in close proximity (Civic Centre car park)

Improved patient experience by providing a high quality environment

Developing our plans

- Working with the London Borough of Bromley, the vacant Adventure Kingdom building on the Civic Centre site (previously temporarily used as a foodbank) will be refurbished to become the new Health and Wellbeing Centre.
- There will be two floors:
 - Ground floor will accommodate the patient facing spaces for the Dysart GP practice
 - First floor will accommodate the patient facing spaces for the outpatient and wellbeing services
- There will be a small car park for staff, an ambulance drop off and parking for blue badge holders
- The exterior of the building will be improved



How will our plans impact you?

The local community will be able to access more services locally

There will be improved access for patients with mobility issues

The Dysart Practice will remain in its current location until the new building is ready – so there will be no disruption to current services

Co-location of the health centre with the Civic Centre will enable people to access both NHS and council services

For residents residing in the neighbouring roads to the site, there will be increased traffic during construction. We will make sure that any impact is minimised



Ground Floor

Designs as of 13/12/22
Still in development

Designs

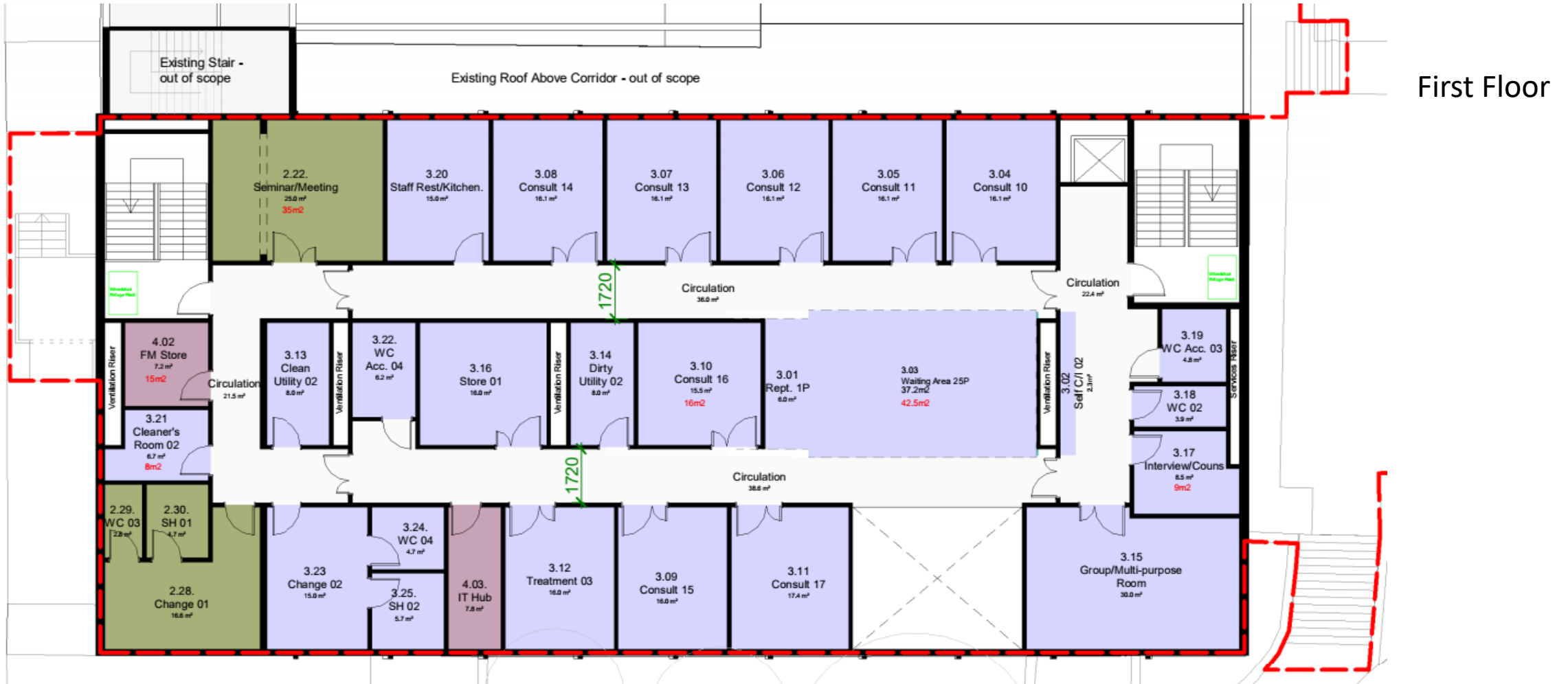

Designs as of 13/12/22
Still in development₁₀

Timelines

- Planning permission has been submitted
- Planning decision expected February 23
- The Full Business Case (FBC) – setting out the commercial arrangements, the final designs and the tendered construction costs will be completed at the end of February 23
- Construction works will go out to tender in January 23 and tender returns will be received in February 23.
- Works will start May 23 and will be complete by March 24.

How you can find out more and get involved

- This is our first meeting with members of the public to explain in more detail our plans.
- We want to hear from you and others about what you think.
- We are planning more opportunities for the public and stakeholders to hear about the new centre and share their views, both online and in person.
- This will include a face-to-face event in Spring 23 at a local and accessible venue where we will share plans and answer questions.
- Please share any feedback by emailing **bromley.contactus@selondonics.nhs.uk**
- We will be setting a up a dedicated project web page which will be regularly updated

Next Steps

- We are awaiting the planning decision
- In the meantime, we will continue to develop the design and to produce the tender packages and documentation
- The FBC once submitted at the beginning of March will need to be approved by the NHS South East London Integrated Care Board and then by NHS England
- Once approval of the FBC has been received, we can progress our plans.

Any questions?